

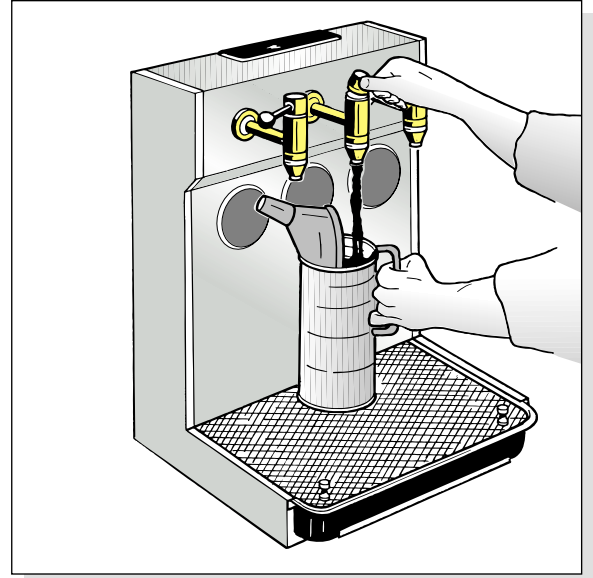

Art. 37691 (with digital meter art.37711)

Art. 37690 (standard with one tap only)



The **oil bar** (oil dispenser) is useful for delivering fluids such as oils **and/or antifreeze liquid**. When connected to an air-operated pump, installed upstream (one for each tap), it is always ready to use. Coming standard with a tap, it is arranged to take another two to enable the **three different types of fluids to be delivered at the same time**.

Art. 37691 Oil bar with digital meter art. 37711

Equipped with tap art.37692
With the possibility of applying a total of:
3 delivery taps art. 37692
3 digital meter kits art. 37696

N° 1 packing m^3 0,136 kg 25

Art. 37690 Oil bar

Equipped with tap art.37692
With the possibility of applying a total of:
3 delivery taps art. 37692
3 digital meter kits art. 37696

N° 1 packing m^3 0,136 kg 23,8

The oil bar offers the possibility of having available three different types of oils or antifreeze liquids, for quick toppings-up or complete changes.

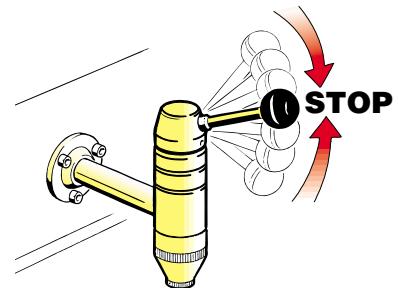

The tap for the **double-valve** oil bar is equipped with an **antisplash filter** to guarantee maximum delivery while preventing annoying sprays caused by eventual air bubbles in the system.

The tap closed automatically as soon as the operator releases the knob.

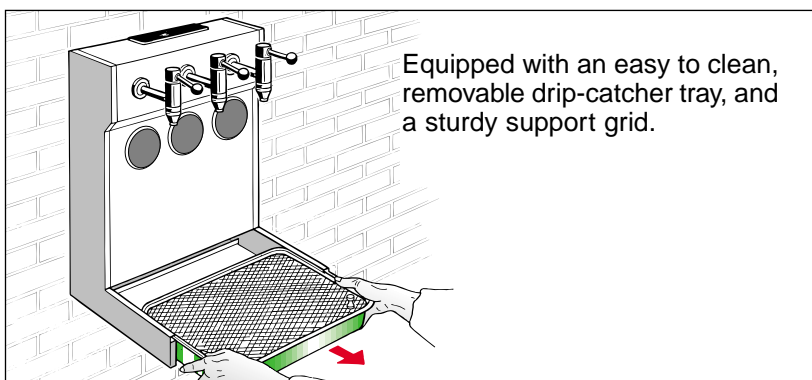

Equipped with an easy to clean, removable drip-catcher tray, and a sturdy support grid.

Overall dimensions

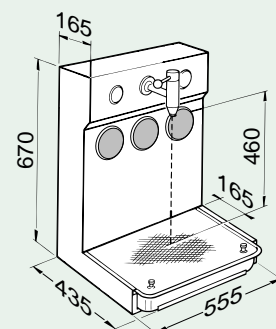

art. 37690 - 37691

EXAMPLE OF INSTALLATION WITH HOSE

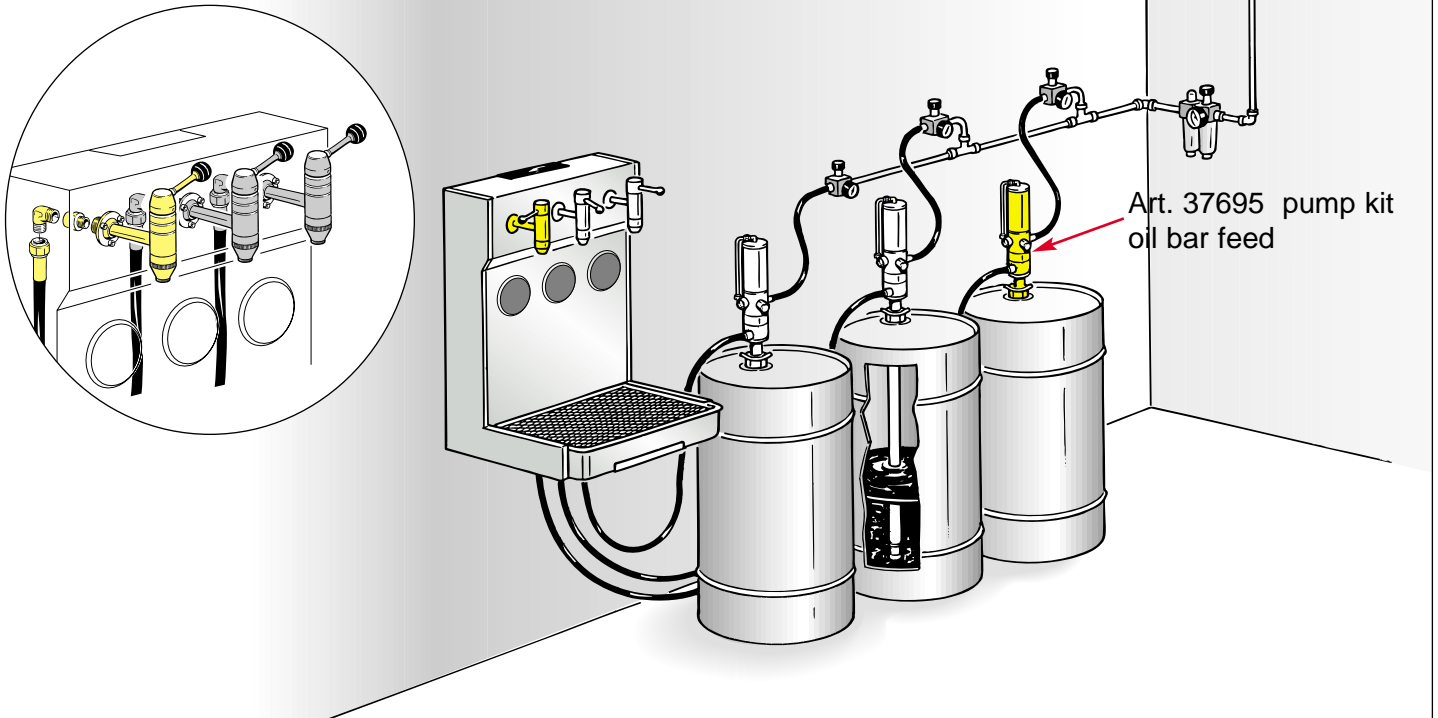

Example of installation of an oil bar with three service taps connected by hoses to the feeder pumps art.37695.

This type of connection is only recommended for short distances.

After the air is connected to the pump, by operating the tap handle, it will always be ready to use.

EXAMPLE OF INSTALLATION TO FIXED SYSTEM

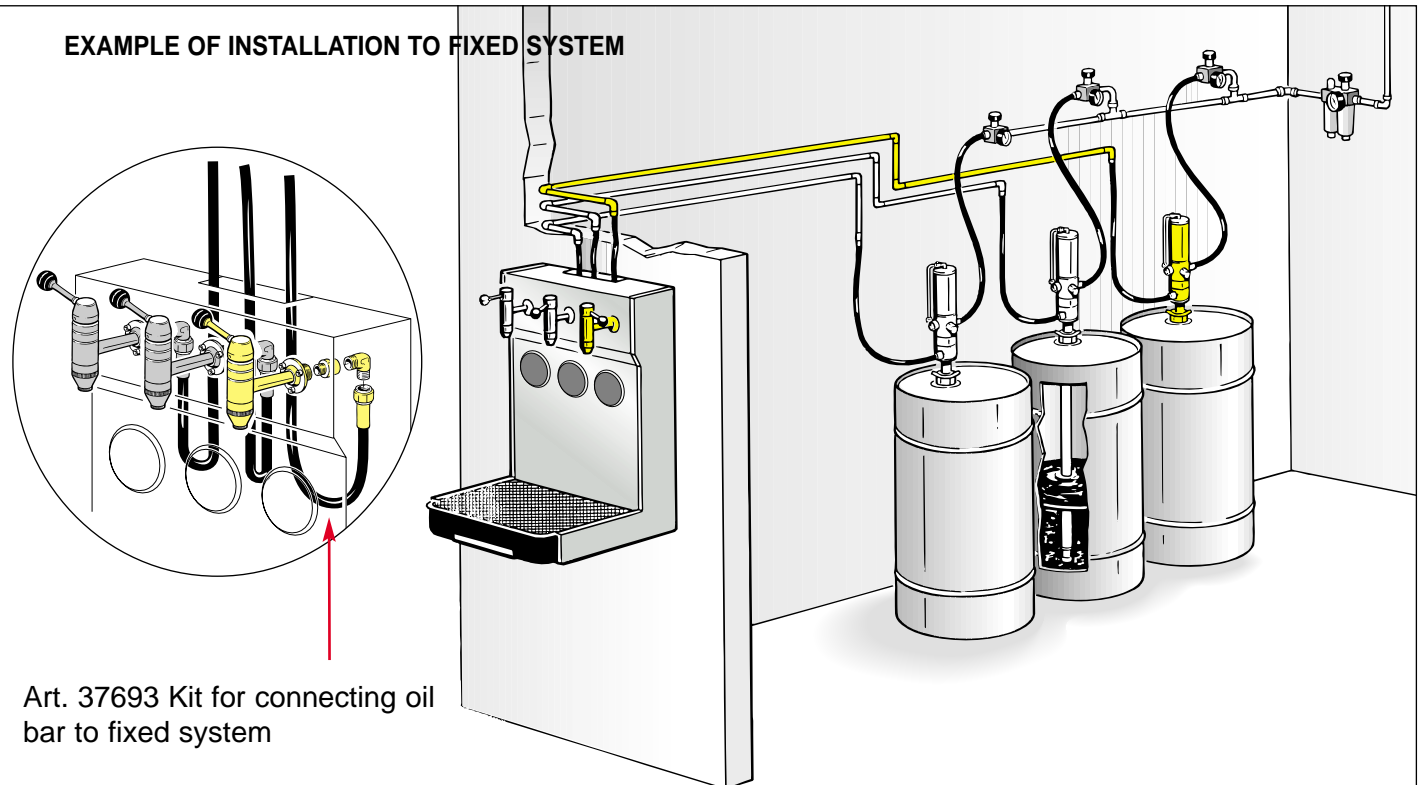

Art. 37693 Kit for connecting oil bar to fixed system

Example of installation to a fixed system with the oil bar connected to a centralized system by means of a 60 cm hose art.37693.