

Air - Water **20** bar



S. 390

S. 430

S. 530

S. 540

S. 560

The same models, swivelling version, on page 343

The **template** supplied, facilitates drilling of the holes and therefore hose reel fixing.



The **quick coupling support** (see page 394) that facilitates installation in battery is available by request.

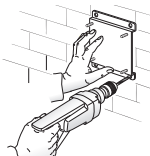

The **adjustable arms** can be easily repositioned according to needs (see page 396).

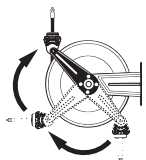

Hose reel with hoses in black synthetic rubber and galvanised steel fittings



- brass swivel joint
- "viton" seals

| Article | Hose length | Hose ø | Connection inlet | Connection outlet |
|----------|---------------|--------------|------------------|-------------------|
| 8392.100 | / | without hose | F 3/8"G | F 3/8"G |
| 8392.101 | 12m (995.211) | 3/8" | F 3/8"G | M 3/8"G |
| 8392.102 | 18m (995.217) | 3/8" | F 3/8"G | M 3/8"G |

No. 1 packing m^3 0,050 from kg 11 to 18

| | | | | |
|----------|---------------|--------------|---------|----------|
| 8432.100 | / | without hose | F 1/2"G | F 1/2"G |
| 8432.101 | 12m (995.212) | 3/8" | F 1/2"G | M 3/8"G |
| 8432.102 | 18m (995.218) | 3/8" | F 1/2"G | M 3/8"G |
| 8432.103 | 10m (996.210) | 1/2" | F 1/2"G | M 1/2"G |
| 8432.104 | 15m (996.215) | 1/2" | F 1/2"G | M 1/2" G |

No. 1 packing m^3 0,065 from kg 14 to 24

| | | | | |
|----------|---------------|--------------|---------|---------|
| 8532.100 | / | without hose | F 1/2"G | F 1/2"G |
| 8532.101 | 20m (996.220) | 1/2" | F 1/2"G | M 1/2"G |
| 8532.102 | 25m (996.225) | 1/2" | F 1/2"G | M 1/2"G |

No. 1 packing m^3 0,065 from kg 19 to 42

| | | | | |
|----------|---------------|--------------|---------|---------|
| 8542.100 | / | without hose | F 1"G | F 1"G |
| 8542.101 | 15m (997.215) | 3/4" | F 1"G | M 3/4"G |
| 8542.102 | 20m (997.220) | 3/4" | F 1"G | M 3/4"G |
| 8542.103 | 15m (998.215) | 1" | F 1"G | M 1"G |
| 8542.105 | / | without hose | F 1/2"G | F 1/2"G |
| 8542.106 | 30m (996.230) | 1/2" | F 1/2"G | M 1/2"G |

No. 1 packing m^3 0,120 from kg 24 to 40

| | | | | |
|----------|---------------|--------------|---------|---------|
| 8562.100 | / | without hose | F 1"G | F 1"G |
| 8562.101 | 30m (997.230) | 3/4" | F 1"G | M 3/4"G |
| 8562.103 | 40m (997.240) | 3/4" | F 1"G | M 3/4"G |
| 8562.104 | 20m (998.220) | 1" | F 1"G | M 1"G |
| 8562.105 | 30m (998.230) | 1" | F 1"G | M 1"G |
| 8562.106 | / | without hose | F 1/2"G | F 1/2"G |
| 8562.107 | 40m (996.240) | 1/2" | F 1/2"G | M 1/2"G |
| 8562.108 | 50m (996.250) | 1/2" | F 1/2"G | M 1/2"G |
| 8562.109 | 60m (996.260) | 1/2" | F 1/2"G | M 1/2"G |

No. 1 packing m^3 0,200 from kg 30 to 80

OVERALL DIMENSIONS

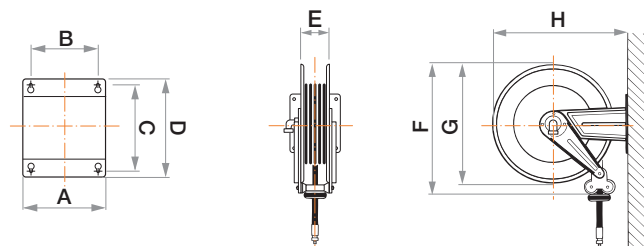

| Art. | A | B | C | D | E | F | G | H |
|--------|-----|-----|-----|-----|-----|-----|-------|-----|
| S. 390 | 186 | 140 | 196 | 226 | 110 | 400 | ø 390 | 410 |
| S. 430 | 186 | 140 | 196 | 226 | 115 | 460 | ø 420 | 460 |
| S. 530 | 203 | 153 | 220 | 258 | 115 | 550 | ø 510 | 560 |
| S. 540 | 300 | 218 | 228 | 268 | 190 | 550 | ø 510 | 573 |
| S. 560 | 488 | 399 | 238 | 272 | 368 | 522 | ø 510 | 578 |